

ALL SIGN SYSTEMS

YOUR SIGN OUR SYSTEM

Banding Tool Instructions

For use with Band-it Stainless Strapping



Band may be used from bulk roll as this completely eliminates waste of band. Slide buckle on band as shown, bringing end of band around object to be clamped and again through buckle.

NOTE: The tension screw thread should be lubricated regularly.



Continue band around object once more and again through buckle. Double banding develops a great deal more radial compression than single banding. Bend end of band under buckle.

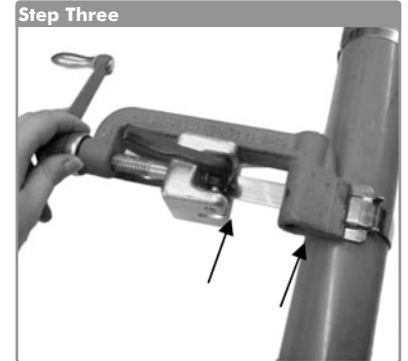

Place band in opening of tool nose and gripper block. Move into slot as far as possible, to avoid buckle sliding into tool nose. Tighten band clamp by turning the tension handle clockwise while holding band gripper tight against band. *NOTE: The spring load of the band gripper is not intended to secure and prevent band from slipping during tension process.*



Place finger on BAND-IT Band at buckle bridge while tensioning with tool handle. When you feel BAND-IT Band stop moving through buckle as you are turning handle, maximum pressure is being exerted by the BAND-IT Band around object being clamped. Stop turning handle.



Roll tool over buckle, backing off with tension handle throughout entire rolling operation. Failure to back off with tension handle through-out entire course of roll-over may result in breaking of band. There is no loss of tension as band released is used up in the bend.



Pull cutting handle to cut the band.

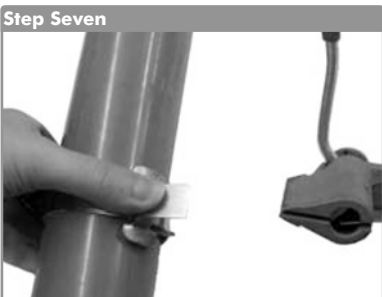

Remove tool, holding stub of band down with thumb.



Hammer down buckle ears to hold band stub in place to complete BANDIT clamp



Order Code: RW100TOOL

 sales@allsignsystems.nz

 09 930 1258

 www.allsignsystems.nz